

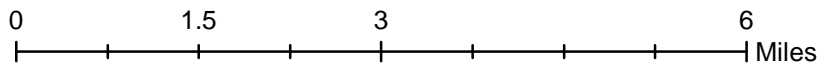

Volunteer Wildlife Monitoring Program (VWMP) Frog and Toad Survey

Route ID: 19 County: Jackson

Click for Google Maps to Site 1: <https://www.google.com/maps/dir/?api=1&destination=42.1336078812,-90.7130517832>

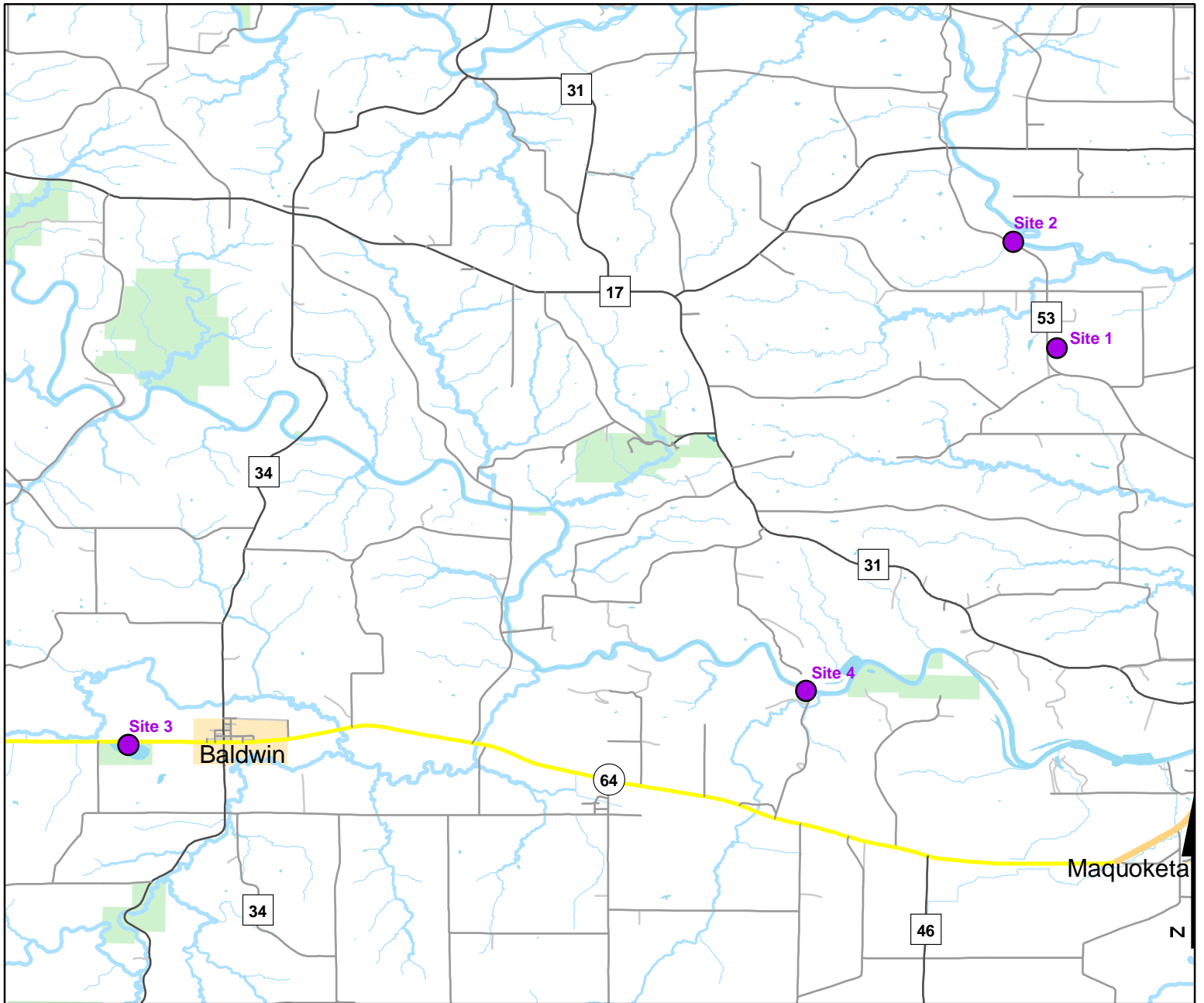

DNR
**Volunteer
 Wildlife
 Monitoring
 Program**

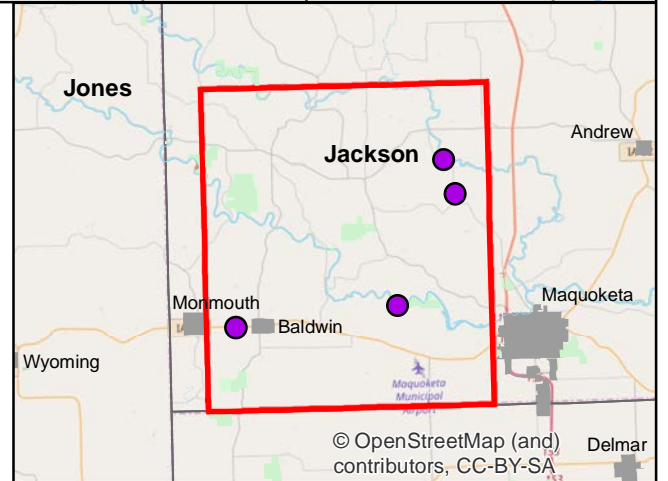

© OpenStreetMap (and) contributors, CC-BY-SA



Volunteer Wildlife Monitoring Program (VWMP) Frog and Toad Survey

Route ID: 19 County: Jackson

Click for Google Maps to Site 1: <https://www.google.com/maps/dir/?api=1&destination=42.1336078812,-90.7130517832>

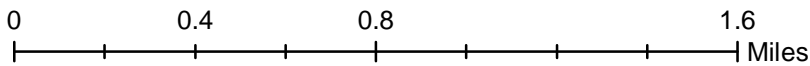
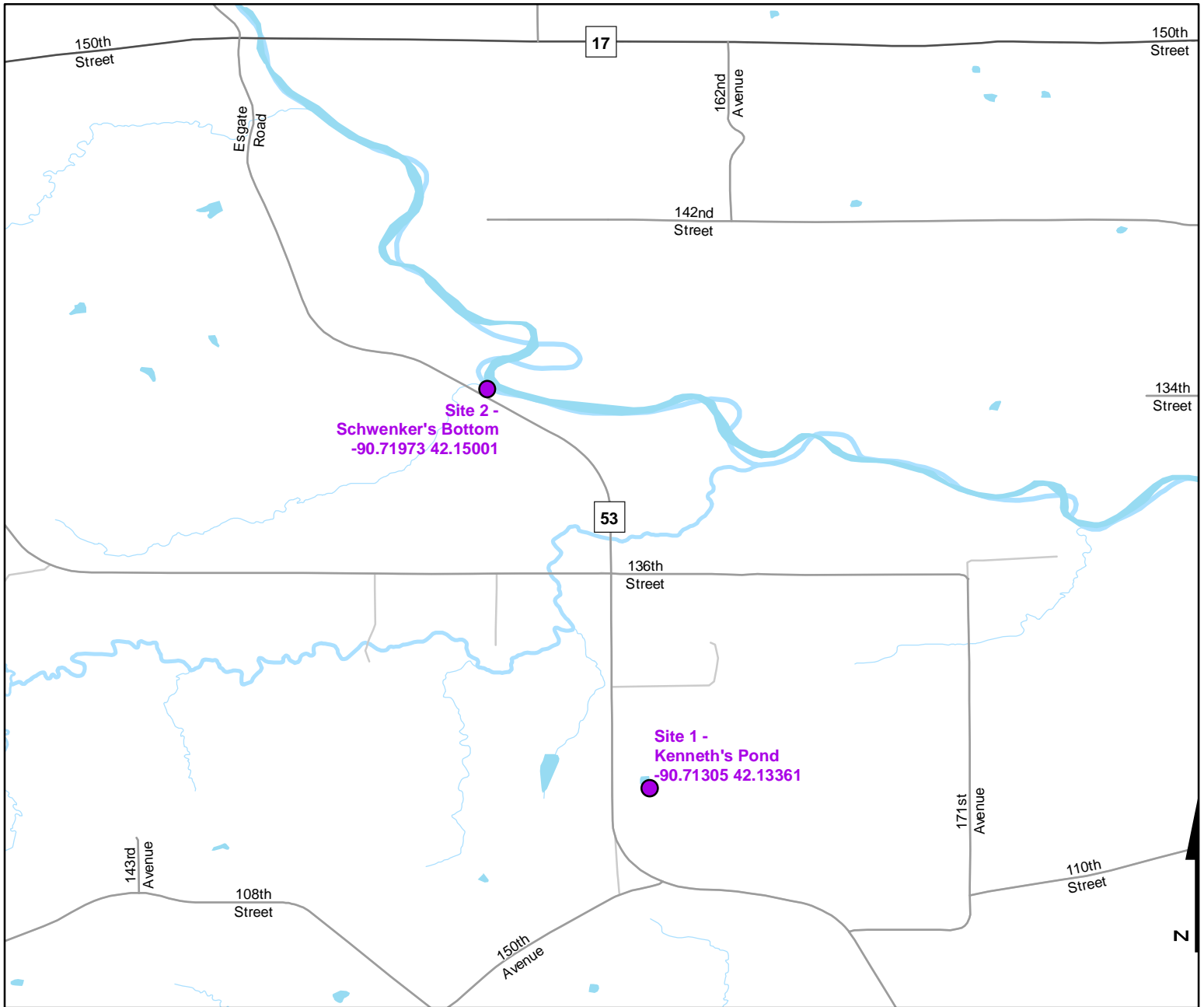

DNR
**Volunteer
 Wildlife
 Monitoring
 Program**

Legend

----- Trails

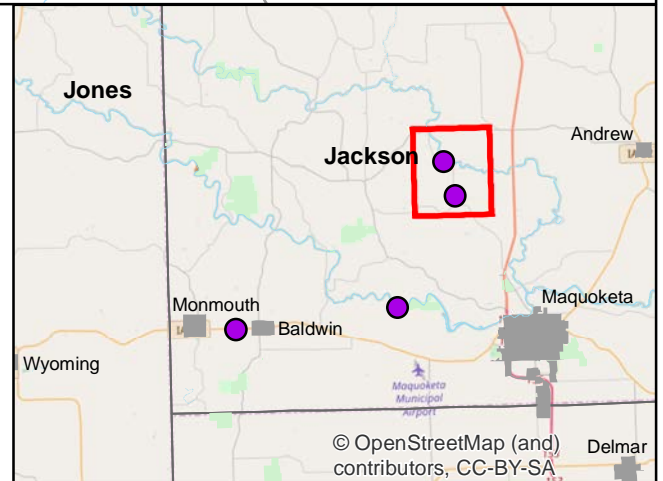

© OpenStreetMap (and) contributors, CC-BY-SA



Volunteer Wildlife Monitoring Program (VWMP) Frog

Route ID: 19 County: Jackson

Click for Google Maps to Site 1: <https://www.google.com/maps/dir/?api=1&destination=42.1336078812,-90.7130517832>

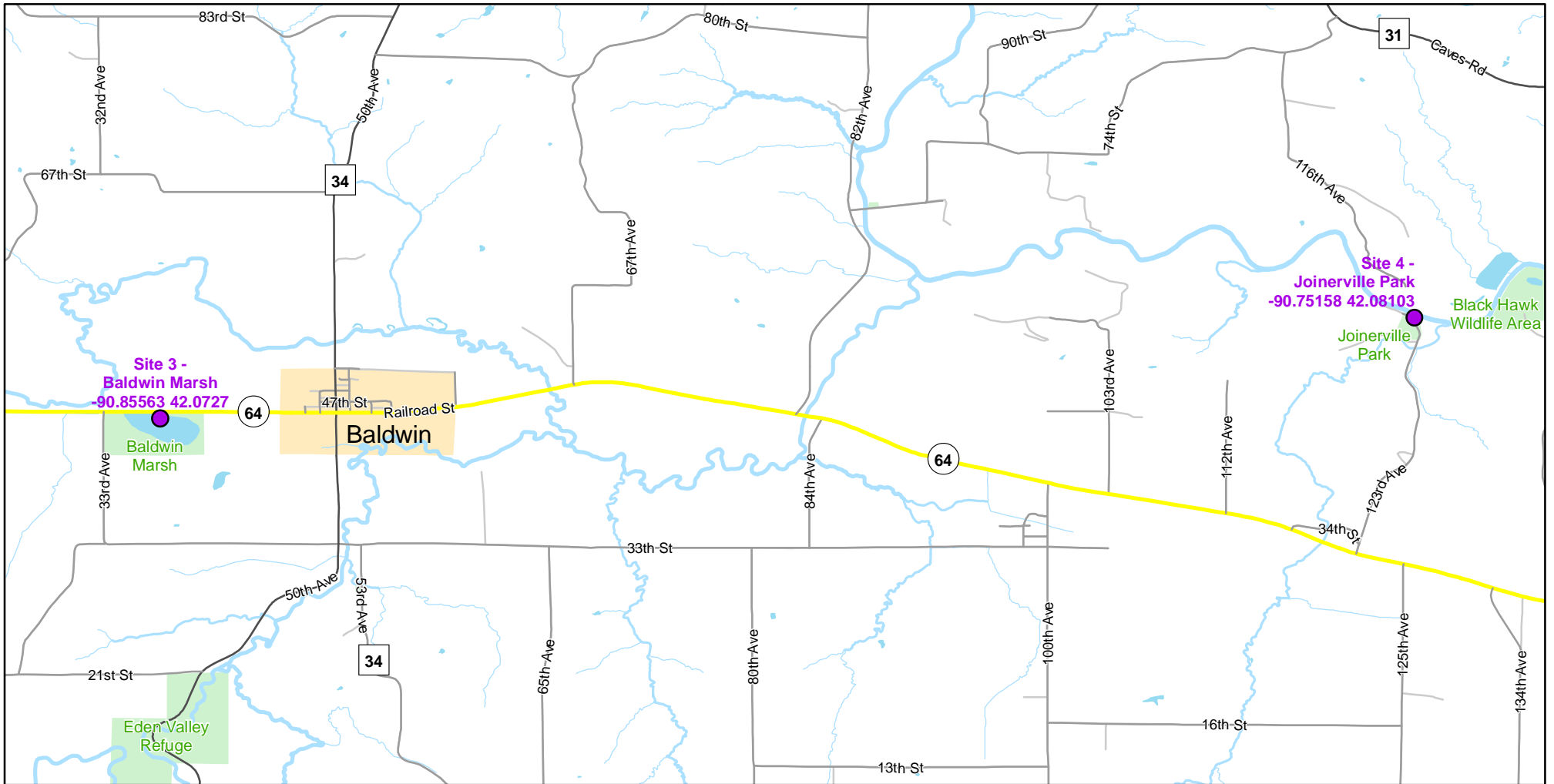

Enlarged View of Site 4



Legend

----- Trails

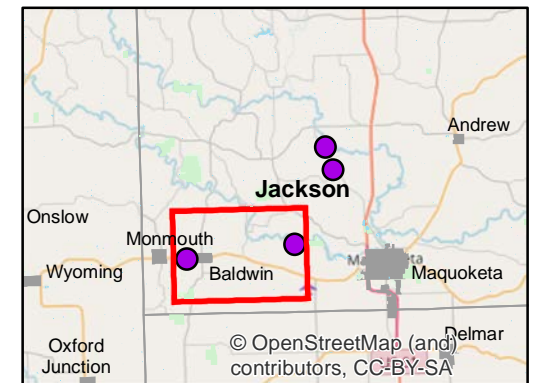
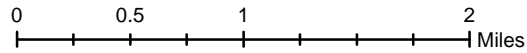

© OpenStreetMap (and) contributors, CC-BY-SA

© OpenStreetMap (and) contributors, CC-BY-SA



Frog and Toad Call Survey Route Description

Route ID **19**

Established: 1991

Site Number	Name	County	Latitude	Longitude	Directions
1	Kenneth's Pond	Jackson	42.1336079	-90.7130518	Access pond through field gate on east side of Esgate Rd., 3.5 mile north of Hwy 61. Across road from white house and steel machine shed.
3	Schwenker's Bottom	Jackson	42.1500143	-90.7197344	West side of road, 4 3/4 mile north of hwy 61 on Esgate road where Maquoketa river comes right beside the road. There is an access lane of hwy to put canoes in on right (east)
4	Baldwin Marsh	Jackson	42.0727	-90.8556256	3/4 mile west of Baldwin on south side of road. Listen from Road side.
5	Joinerville Park	Jackson	42.0810285	-90.7515839	Boat ramp at Joinerville Park. At end of Joinerville rd. (123rd Ave).